

EA

ENROLLED AGENT EXAM INSTITUTE™

SPONSOR PROSPECTUS



**EA MASTERY RETREAT
AT CHATEAU ÉLAN**

EA MASTERY RETREAT AT CHÂTEAU ÉLAN

SPONSORSHIP PROSPECTUS 2026

HOSTED BY THE EA EXAM INSTITUTE™

Executive Overview

The EA Mastery Retreat at Château Élan is a premier 3-day immersive training experience curated for tax professionals preparing for the IRS Special Enrollment Examination (SEE). Hosted by the EA Exam Institute™, the retreat blends expert-led instruction, advanced leadership training, and refined networking in a luxury resort environment designed to cultivate mastery, confidence, and professional excellence

Over the course of three transformative days, attendees will engage with IRS-approved educators, participate in hands-on study labs, and enjoy elevated learning experiences that combine technical education with personal development. Beyond passing the EA Exam, participants gain the strategic insight to lead, scale, and influence as top-tier tax professionals in a competitive marketplace.

Why Sponsor the EA Mastery Retreat

Sponsoring the EA Mastery Retreat at Château Élan positions your brand among the most respected names in tax education and professional development. The retreat's exclusive audience includes established firm owners, educators, IRS Enrolled Agents, and emerging professionals who invest in the tools, technology, and partnerships that drive the tax industry forward.

Your sponsorship directly supports the growth of America's next generation of Enrolled Agents, while positioning your brand in front of a national audience of trusted tax professionals.

Connect with decision-makers and influencers shaping the future of tax representation and practice.

Audience Profile

- Ambitious attendees representing tax firms, government agencies, and private practices
- Mid- to senior-level professionals pursuing or maintaining Enrolled Agent (EA) certification
- Decision-makers responsible for software, systems, and continuing education investments
- Speakers, educators, and practitioners recognized nationally for advancing the profession

Sponsorship Levels & Benefits

Don't miss this opportunity to connect with decision-makers, elevate your brand, and position your company directly in front of top tax professionals and industry leaders.

Level	Investment	Includes
Platinum Partner	\$8,500	<ul style="list-style-type: none">• Presenting Sponsor recognition throughout the retreat• Two full-page features or advertisements in the retreat guide• VIP table brunch experience with four VIP passes• Keynote introduction or featured speaking moment• Premium exhibit placement and high-visibility branding• Featured in all press releases and digital campaigns• Logo placement across signage, materials, and website• Access to the attendee list (opt-in)• Inclusion in welcome packages• All benefits from Gold, Silver, and Bronze levels
Gold Partner	\$7,500	<ul style="list-style-type: none">• Co-branding for a networking reception or breakout session• One full-page ad or feature in the retreat guide• Priority exhibition placement• Logo featured on signage and digital promotions• Two event passes• Distribution of branded materials• Recognition during general sessions• All benefits from Silver and Bronze levels
Silver Partner	\$6,000	<ul style="list-style-type: none">• Sponsorship of one breakout session or workshop• Ten-minute sponsor webinar before or after the retreat• Logo included in signage and materials• One event pass and exhibition table access• Quarter-page ad or listing in the retreat guide• Inclusion of promotional materials in welcome bags• All benefits from Bronze level
Bronze Partner	\$3,000	<ul style="list-style-type: none">• Logo placed on retreat website, program guide, and select signage• One general admission pass• Listing in the sponsor directory• Inclusion of one promotional item in welcome packets
Vendor / Exhibitor	\$1,500	<ul style="list-style-type: none">• Standard exhibit table with signage in a high-traffic area• Listing in vendor directory and retreat guide• Engagement with attendees during networking sessions• Distribution of brochures, flyers, or branded giveaway items



For sponsorship inquiries or vendor registration:

Website: www.irseaexam.com

Email: admin@irseaexam.com

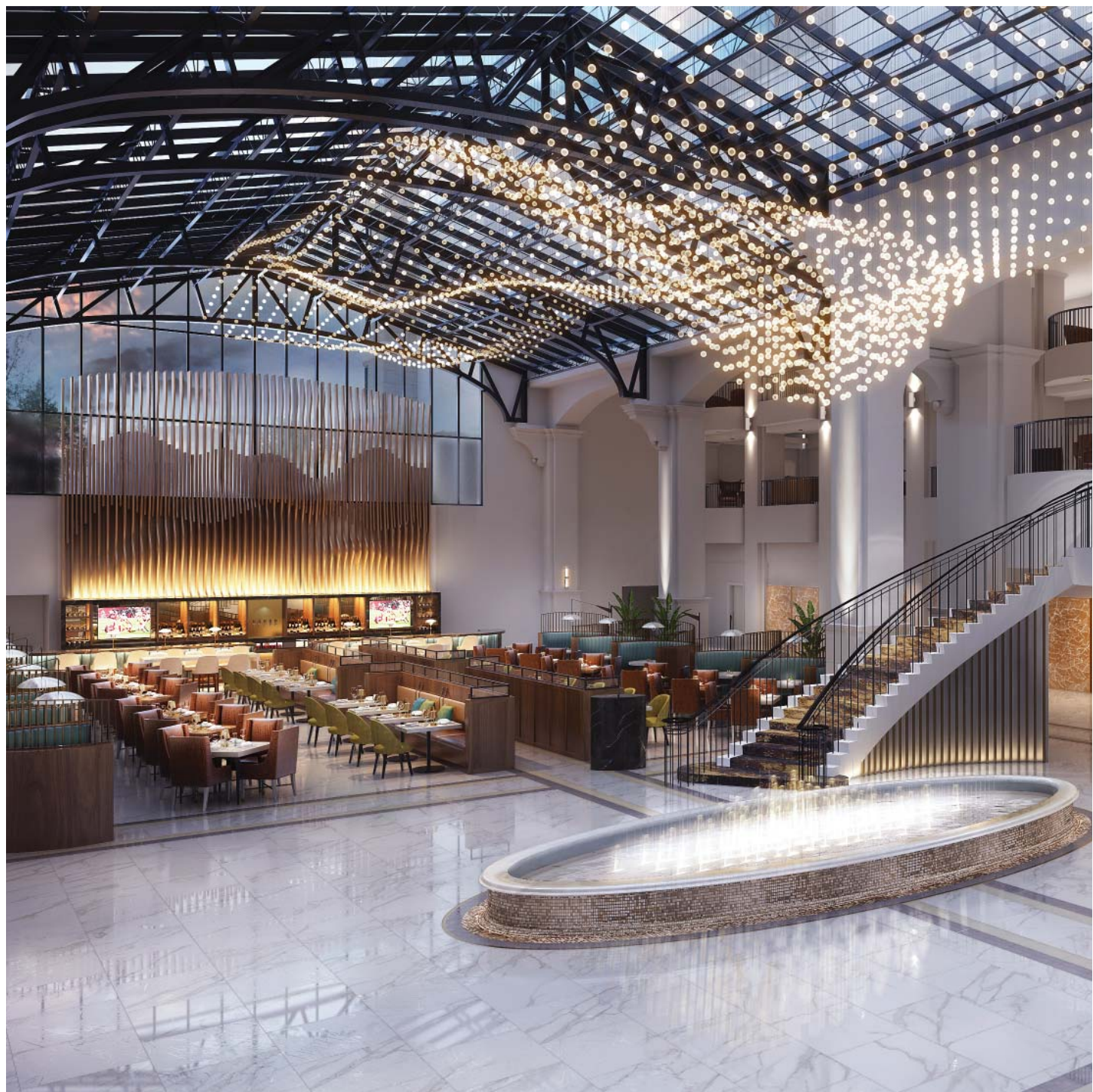

CHÂTEAU ÉLAN WINERY & RESORT

WELCOME TO ATLANTA'S PREMIER CONFERENCE DESTINATION



A PERSONALIZED COMMITMENT TO EXCEED YOUR HIGHEST EXPECTATIONS

The Inn at Château Élan is designed to provide guests with the utmost feeling of relaxation and approachable luxury. Capturing the French country's architectural flair, the resort's 329 rooms and suites revolve around French blue with muted shades evocative of the sun-drenched Mediterranean. Our fresh take on French estates incorporates soft golds, creams, blues and browns throughout to promote a warm air of comfort and well-being. The luxurious bedding package boasts embroidered white linens atop a cushy pillow-top mattress — key ingredients for a good night's rest following a full day of activities. Each guest room has a large work desk, high-speed wireless internet, flat-screen television, mini-fridge, terrycloth robes and a lavish bathroom with an oversized tub and separate shower. Guests also have access to a fitness center, outdoor pool and hot tub.

Château Élan takes pride in its commitment to personal attention and guest services, along with a desire to exceed your highest expectations. It offers a unique sense of place staffed with hospitality professionals from around the world, contributing a captivating international flavor to the resort. The warm and cheerful ambiance that greets you upon arrival and accompanies you throughout your stay makes Château Élan an all-around gratifying venue.





A DEDICATED PROFESSIONAL STAFF TO FACILITATE YOUR BUSINESS



With our 40,000 square-foot conference center, 10,000 square feet of outdoor meeting space, state-of-the-art technology and dedicated professionals on staff, we make your goals our goals. From meeting rooms to grand ballrooms, the facility can accommodate groups of 15 to 1500, fulfilling all of your needs to host productive meetings. The 20 meeting rooms feature permanent refreshment kiosks and individual access to the outdoors. The stepped auditorium with a fixed stage seats 60 attendees, providing a remarkable environment for any presentation. With Château Élan's superior facilities and continued commitment to excellence, its unrivaled record of success has earned it numerous awards as a top meeting destination.



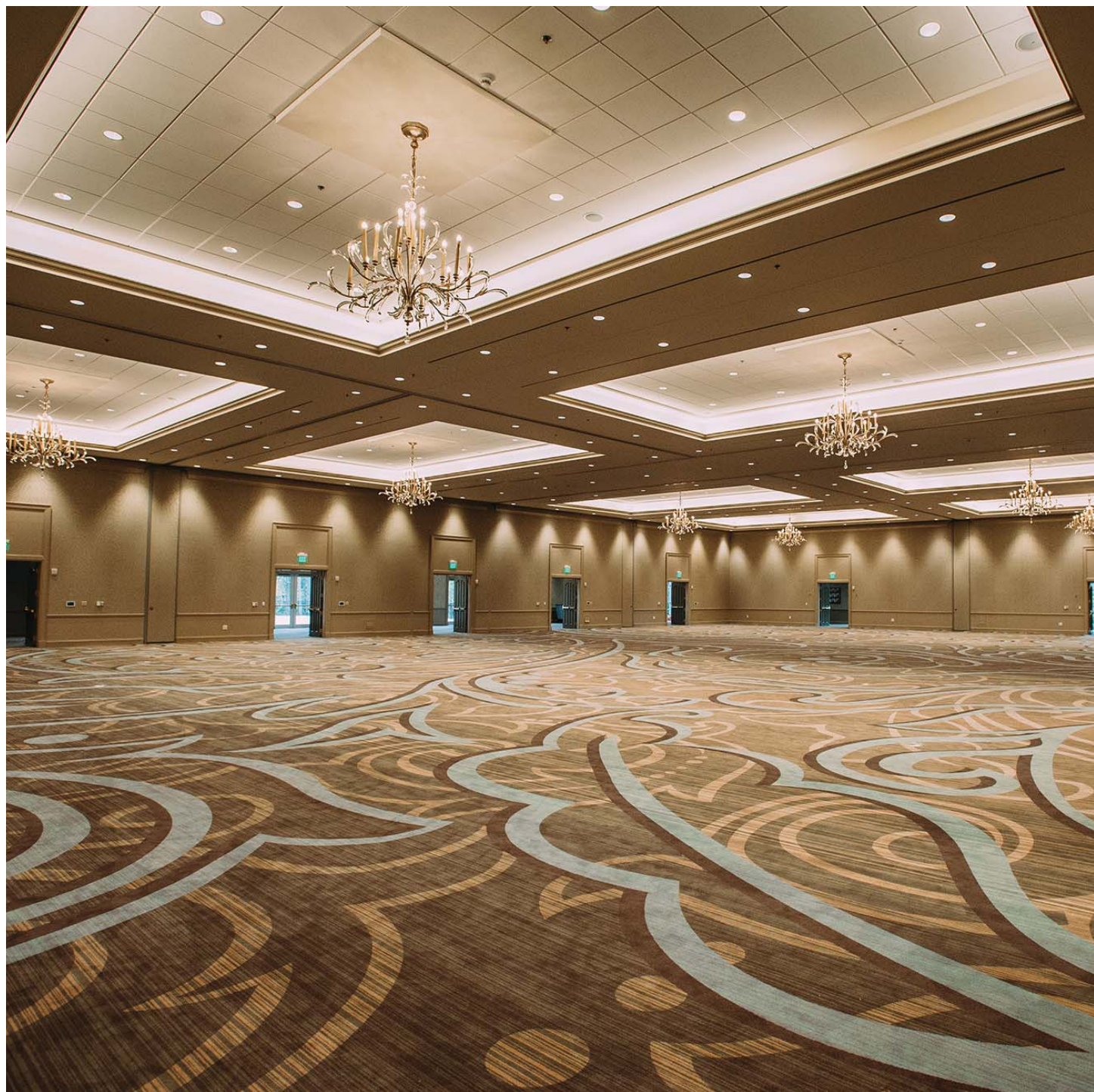

MAGNIFICENT VENUES ENCOURAGE AGENDAS LIMITED ONLY BY IMAGINATION



Château Élan's 3,500 acres of diverse landscapes and venues, combined with a creative staff of conference professionals, will turn your imagination into reality. An array of outings and activities await you. Whether you prefer fun and light-hearted events beneath Georgia's blue skies or dramatic evenings under starry nights, Château Élan has it all. You can plan an active day outdoors with company tournaments and instructional clinics, then unwind over gourmet food and wine in the evening.





MEMORABLE MEETINGS ARE LIKE A FINE WINE, BOTH HAVE A NICE FINISH



The winery features 11 distinct venues for meetings, banquets and receptions accommodating between 30 and 500 guests. The rustic setting of the cask room creates truly unforgettable events for your attendees with themed dinners and receptions.

Guests can network over our award-winning selection of more than 28 wines with private winery tours and tastings, attend interactive classes in our Viking® culinary studio, and participate in teambuilding exercises such as winemaking workshops and wine blending classes.





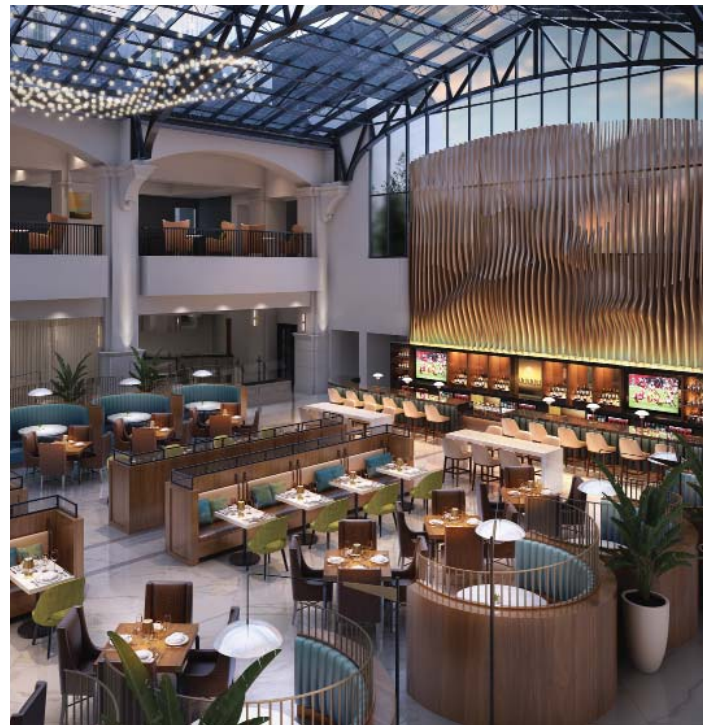

WINES & SUCCULENT DISHES – A DECADENT CULINARY ADVENTURE.

Château Élan's expert team of culinary professionals craft an array of international dishes with a regional flair. The 7 distinctive dining outlets offer cuisine ranging from thoughtfully-crafted pub fare at the spirited Paddy's Irish Pub to succulent spa cuisine at Fleur de Lis. The resort takes pride in using locally-sourced produce in its dishes as highlighted at Marc which features a hand-curated menu featuring regional favorites. Menus for banquets and catered affairs are designed around superb ingredients and seasonal considerations, and are complemented with artisan sauces carefully prepared with depth and flavor. The diverse range of dining options available throughout the resort, enhanced with the bounty of award-winning wines, is sure to provide guests with a delectable experience that perfectly suits their palate and your busy schedule.



COMING TOGETHER IS A BEGINNING. KEEPING TOGETHER IS PROGRESS.
WORKING TOGETHER IS SUCCESS.

Château Élan and its one-of-a-kind amenities guarantee immensely rewarding meetings. The 3,500-acre estate is rich with diverse landscapes that not only make great venues, but also encourage fun, interactive teambuilding activities. Our expert team of planners can customize experiences that are perfectly tailored to your company's goals, from relationship-strengthening indoor and outdoor team activities to motivational community outreach initiatives. Bring your own equipment or rent the latest models here and we'll create private company golf tournaments or tennis matches. Guests can also play volleyball, basketball, hike and bike our expansive nature trails, or work out at the health club, followed by a refreshing plunge in our outdoor pool.





A BEGUILING SETTING FOR A WELL DESERVED SOJOURN

Celebrated as Atlanta's only spa destination experience. The Spa at Château Élan rejuvenates the body, mind and soul. The 35,000-square-foot full-service European spa is nestled inside a lakeside mansion featuring 14 luxurious overnight guest rooms that are surrounded by a canopy of forest trees, emerald green lawns and flowering shrubs. The Spa's own healthy gourmet restaurant Fleur-de-Lis contributes to an all-over feeling of wellness and relaxation, which can be enjoyed before or after treatments in the comfort of your robe and slippers. Whether it's between demanding conference schedules or for an extended stay, the Spa, with 35 treatment rooms, a staff of 90 and 14 luxury overnight guest suites, is a superbly relaxing experience like no other.





THE SOUTH'S PREMIER TOURNAMENT EXPERIENCE

Few places resonate more with a sheer sense of pleasure and challenge than on Château Élan's 45 holes of championship golf. Memorable views of undulating fairways, cool lakes, tree-lined holes and tightly woven carpets of greenery punctuated with clever sand traps will delight players of every caliber. For an entertaining and interactive experience during your group's stay, we can arrange golf tournaments for up to 450 participants, as well as individual or group lessons and clinics hosted by the respected Dave Pelz Scoring Game School. The beautiful 1,100 yard, nine-hole par-3 Executive Course is an ideal venue for group night golf outings or for players who do not have time for a full 18. Golf amenities include a full-service renovated clubhouse and pro-shop managed by Troon, Sarazen's Bar & Grille, a large golf pavilion, and 14 two, three and four bedroom luxurious golf villas and cottages.



